



INN and SPA
at LORETTO
SANTA FE



A Heritage Hotels & Resorts Property

AUTHENTIC SOUTHWESTERN STYLE

Welcome to an iconic Inn and Spa at Loretto, a boutique, luxury hotel in Santa Fe immersed in the culture and sophistication of New Mexico.



INN AND SPA AT LORETTO

Inspired in design by the Taos Pueblo — one of three UNESCO World Heritage sites in New Mexico — the Inn and Spa at Loretto is widely regarded as one of the most photographed structures in Santa Fe — and for good reason. This AAA 4-Diamond resort epitomizes the intrigue of northern New Mexico through artistic design, world-class accommodations, and convenience. Located in the heart of Santa Fe and within immediate walking distance to the city's top attractions — such as the historic Santa Fe Plaza, Palace of the Governors, and the world-renowned “Artist Row” galleries of Canyon Road.

ACCOMMODATIONS

Drawing design inspiration from one of the most iconic landmarks in the southwest — the Taos Pueblo UNESCO World Heritage Site — each of the guestrooms at the Inn and Spa at Loretto hold true to this cultural influence with Native American and organic accents. Some rooms, including the Penthouse Suite, feature kiva fireplaces and a wealth of craftsmanship that reflect the culture and sophistication of Santa Fe.

LOCAL ATTRACTIONS

- Santa Fe Community Convention Center
- Historic Santa Fe Plaza
- Downtown Museums and Museum Hill
- Artist Row of Canyon Road
- Lensic Performing Arts Center
- Georgia O’Keeffe Museum
- Santa Fe Culinary Institute
- New Mexico State Capitol
- Palace of the Governors

MEETING FACILITIES

- 12,000 sq. ft. Flexible Event Space
- 3,000 sq. ft. Chaco Ballroom
- 2,700 sq. ft. Zuni Ballroom with French Doors that Open to the Lush Event Grounds
- 2,300 sq. ft. Tesuque Ballroom with a Fireplace
- The Only Penthouse Suite in Santa Fe
- On-Site Catering
- Audio/Visual Services

PROPERTY FEATURES

- Valet Parking
- Premier Outdoor Pool
- Fitness Center
- The Spa and Salon at Loretto
- Luminaria Restaurant & Patio
- Crafted Café & Tasting Room
- The Living Room
- Room Service
- The Shops at Loretto

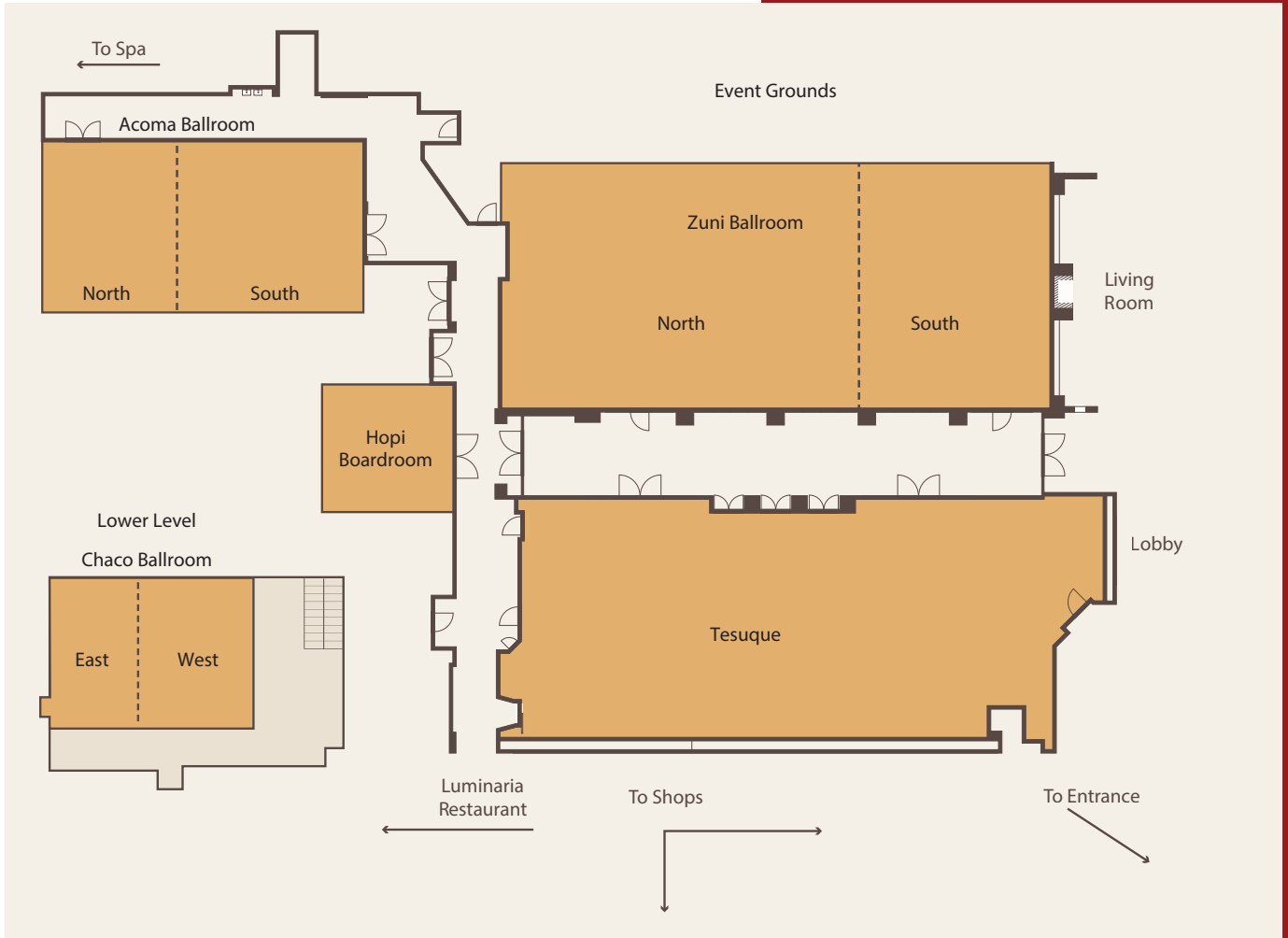

ROOM CAPACITIES

| | Total Sq. Ft. | Room Size | Ceiling Ht | Classroom | Theater | Banquet | Reception | Conference | U-Shape | H-Square |
|--------------------|---------------|-----------|------------|-----------|---------|---------|-----------|------------|---------|----------|
| Acoma Room | 1,352 | 52' x 26' | 9' | 63 | 100 | 100* | 100 | 40 | 40 | 46 |
| Acoma North | 624 | 24' x 26' | 9' | 27 | 45 | 50* | 40 | 18 | 20 | 24 |
| Acoma South | 728 | 28' x 26' | 9' | 27 | 45 | 50 | 50 | 18 | 20 | 24 |
| Breezeway | N/A | 65' x 26' | 9' | N/A | N/A | N/A | N/A | N/A | N/A | N/A |
| Chaco Ballroom | 2,835 | 63' x 45' | 9' | 117 | 200 | 200 | 150 | 36 | 42 | 48 |
| Chaco East | 1,215 | 27' x 45' | 9' | 63 | 90 | 90 | 90 | 30 | 36 | 42 |
| Chaco West | 1,620 | 36' x 45' | 9' | 63 | 100 | 100 | 100 | 30 | 36 | 42 |
| Chaco Pre-Function | N/A | 30' x 18' | N/A | N/A | N/A | N/A | N/A | N/A | N/A | N/A |
| Hopi Boardroom | 342 | 18' x 19' | 9' | 12 | 20 | 20 | 15 | 12 | 9 | 12 |
| Event Grounds | N/A | 50' x 40' | N/A | N/A | 200 | 200 | 250 | N/A | N/A | N/A |
| Sunset Terrace | N/A | N/A | N/A | N/A | N/A | 40 | 50 | N/A | N/A | N/A |
| Tesuque | 2,345 | 35' x 67' | 14' | 60 | 150 | 100 | 100 | 36 | 40 | 46 |
| Zuni Ballroom | 2,730 | 65' x 42' | 10'6" | 130 | 222 | 240* | 240 | 48 | 55 | 65 |
| Zuni North | 1,680 | 40' x 42' | 10'6" | 54 | 126 | 120 | 120 | 36 | 36 | 48 |
| Zuni South | 1,050 | 25' x 42' | 10'6" | 36 | 96 | 90 | 80 | 30 | 30 | 35 |

Inn and Spa at Loretto
HotelLoretto.com

211 Old Santa Fe Trail, Santa Fe, New Mexico 87501
Hotel 505.988.5531 Reservations 866.582.1646
sales@hhandr.com



El Monte Sagrado | Eldorado Hotel & Spa | Inn and Spa at Loretto | Hotel St. Francis | Hotel Chimayó de Santa Fe
Hotel Chaco | Hotel Albuquerque at Old Town | The Clyde Hotel | Hotel Encanto de Las Cruces